

Fristam Circumferential Piston Pumps FKL

High suction capability, high speed and high pressure – Fristam circumferential piston pumps provide optimum performance in every respect.

Pump performance

High efficiency:

Even at high pressure the FKL pistons remain completely distortion-free owing to their symmetrical design. In addition, reinforcement prevents the shafts from bending. The Fristam FKL circumferential piston pumps are ideally suited to applications where discharge pressures of up to 30 bar are required with minimised piston wear. FKL pumps are self-priming.

Gentle product handling:

In Series FKL Fristam pumps the new circumferential piston design is used which minimises squeezing and damage to the product.

Backflow:

The casing and cover design reach into the pistons from both sides, which allows only very little backflow due to the area seal on all sides.

Quality

Robust design:

The use of top-class materials, the extremely solid design and small sealing gaps guarantee a remarkable long service life, and worldwide these pumps are defining an unprecedented level of quality. A Fristam FKL pump represents the most perfect solution for reliable, maintenance-free pumping processes.

Optimum hygiene:

Owing to the use of appropriate materials and a design which is devoid of dead zones Fristam circumferential piston pumps are entirely suitable for CIP and SIP.

Economy

Tailor made solutions:

The new piston design and robustness allow use in systems and processes which in the past relied on other – more expensive – elaborate pumping and discharge systems.

Easy maintenance:

FKL pumps with their proven Fristam design fulfil the requirements of service-friendly, problem-free maintenance.

Sizes of FKL

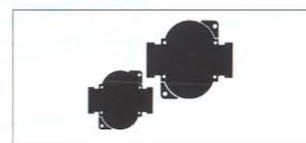

- 8 sizes
- Discharge pressures up to 30 bar
- Flow rates up to 120 m³/h

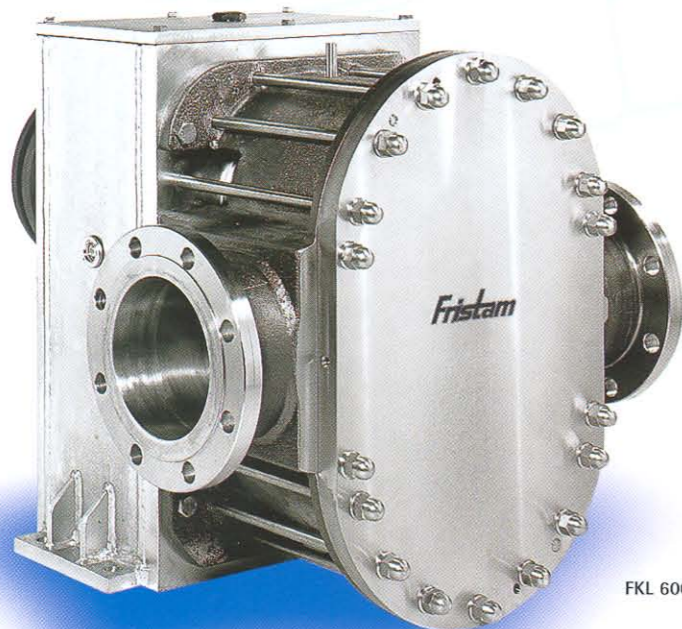

FKL 600 with bare shaft

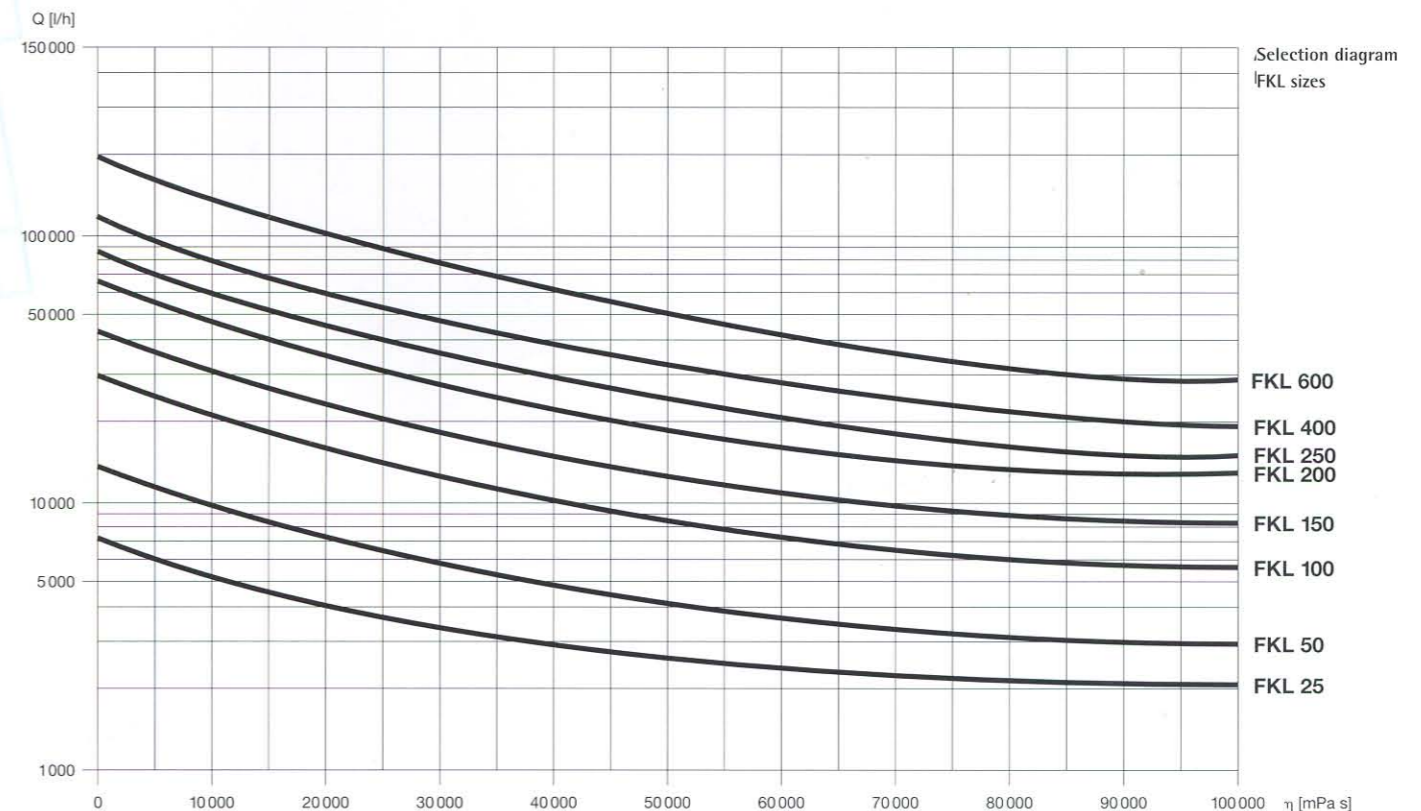

New development FKL with ideal circumferential piston symmetry

The Fristam FKL circumferential piston pumps are characterised by maximum flow and discharge pressure as well as high speeds and a new rotor design.

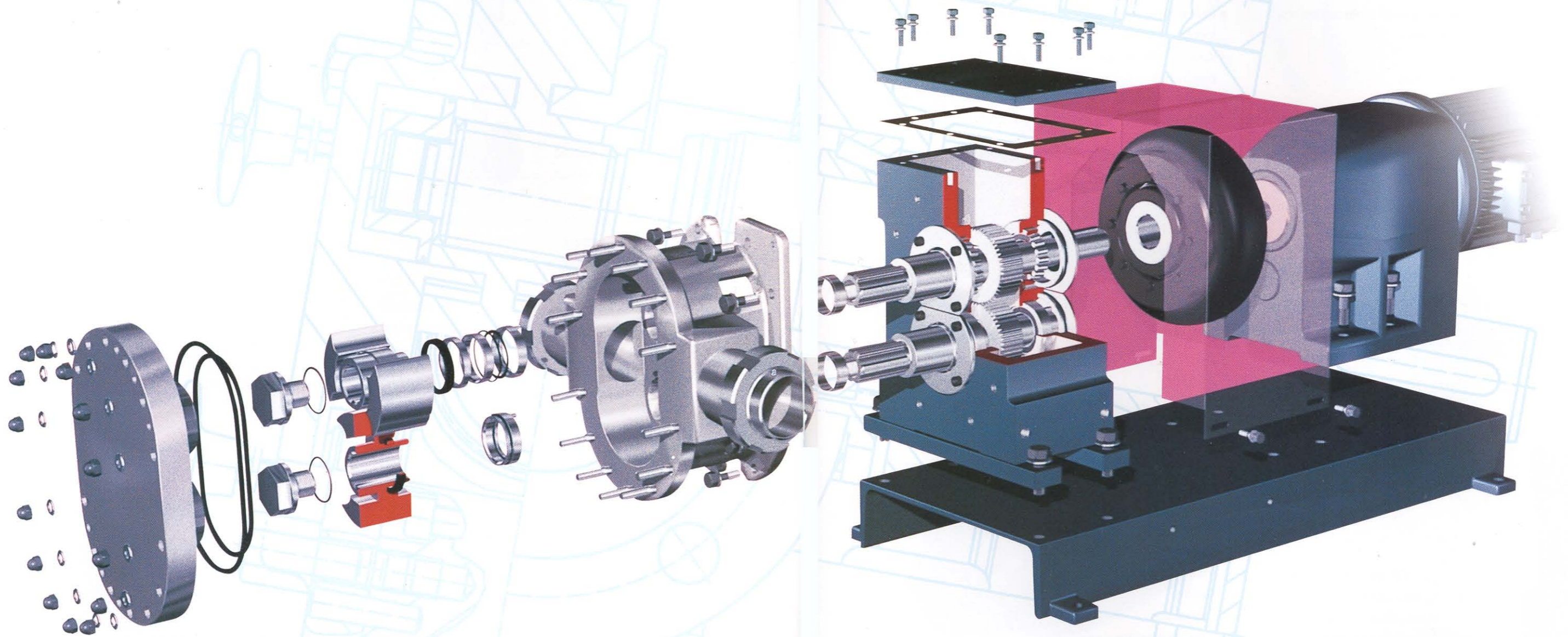

Fristam FK, FL, FKL design options

With a Fristam circumferential piston pump or rotary lobe pump you are always sure of a customised solution because the individual components are tailored to the specific application in your company.

Materials

- Casing, cover and rotors are cast or forged
- Materials
Standard:
 - Other precision-cast materials
 - Materials with less than 0.5 % delta ferrite
- Surfaces in contact with the product:
 - Shotblasted
 - Superfinish turning
 - Ground
 - Polished
 - Electropolished
 - Hardened or coated
 - Special surface finish requirements can be met

Drives

- Geared motor with fixed speed
- Variators with manual, pneumatical or electrical adjustment
Options:
 - Explosionproof
 - Flameproof
 - Suitable for frequency control
 - Special voltages and special frequencies
 - Hydraulic motors
 - other variable speed gear

Rotor types:

- FK
Standard
 - twinlobe
 Options:
 - singlelobe
 - high temperature design
 - spiral grooves
 - straight grooves
- FL
Standard
 - twinlobe
 Options:
 - singlelobe
 - high temperature design

• FKL

- Standard:
 - twinlobe
 Option:
 - high temperature design

Types of connection:

- Threads:
 - DIN 11851, RJT, SMS, ISS,
 - DS, ACME, and others
- Flanges:
 - DIN, ANSI, and others
- Clamps:
 - Tri-clamp, ISO-clamp
- Special connections possible

Special options:

- Heating/cooling jacket
- Pressure relief valve integrated in cover, spring-loaded or pneumatic
- Housing with drain
- Vertical port configuration
- Rectangular inlet port
- Trolleys
- Electronical speed counter
- Digital speed indicator

Further types

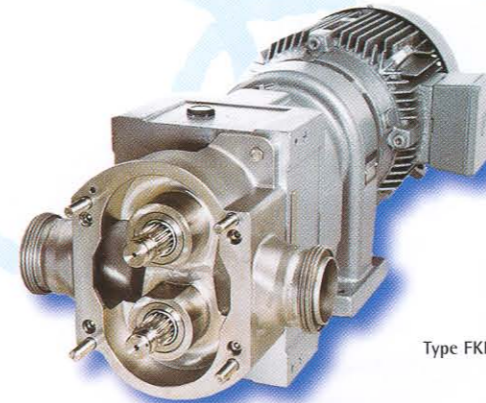

Type FKF

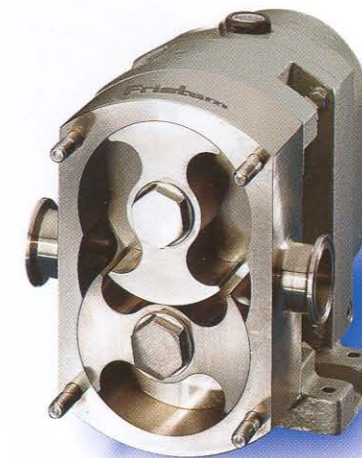

Type FLFN

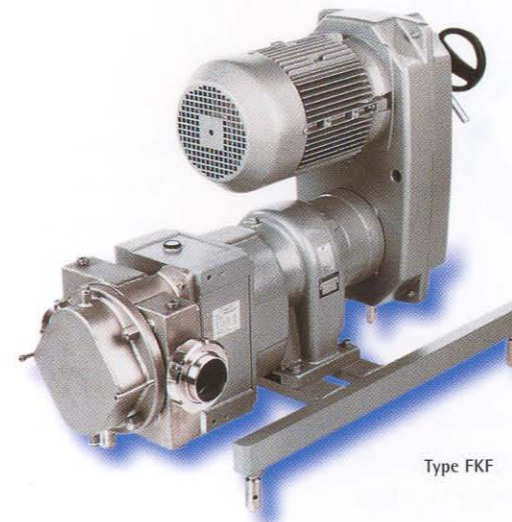

Type FKF

- FKFN, FKN, FLFN, FKL
 - pump with bare shaft or coupling, coupling guard and drive unit mounted on common base frame.

- Option:
 - adjustable legs
 - stainless steel shroud
- FKF
 - Monobloc design with directly flanged drive unit